



ELY • LITTLEPORT • SOHAM

Growth Delivery in East Cambridgeshire

After months of hard work and public consultation, the Ely Masterplan and Soham Vision Masterplan have now both been completed. The two plans set out exciting proposals for the long term future of these two communities.

Throughout the development of the Masterplans, residents have told us how newsletters issued for each plan were really useful in keeping them up to date with progress. As we develop the plans for growth in our District, we felt that it would be useful to continue the newsletters, but to combine the masterplan sheets into just one newsletter.

This is being sent to you because you have, at some stage, expressed an interest in the Masterplan process. If this is no longer the case and you wish to be removed from our database please let us know.

Wherever possible we would prefer to forward this newsletter as an electronic version by e mail. If you have received a paper copy, but would prefer an electronic version please contact the Council as above. We will, of course, continue to send paper copies to those who prefer this format.

Thank you for your interest in these masterplans, and we hope that you find this newsletter informative.

Taking Forward the Ely and Soham Masterplans

Following extensive public consultation work, the Ely Masterplan was approved by Full Council on 23rd February 2010, and the Soham Masterplan Vision approved on 25th May 2010. Work is now progressing on the next stages to take forward the key proposals identified in each of the plans. A Growth Delivery Sub Committee has been set up by the Council to steer this work and provide recommendations to the Council's policy committees on how to take it forward.

The first meeting of this Sub Committee took place on 17th May 2010. They received a report about a series of technical workshops that have been held to progress ideas about the Ely Opportunity sites: North Ely, the City Centre and the Station Gateway. These workshops had been attended by landowners and various statutory agencies, and looked at both possible design concepts for various individual sites as well as commercial viability issues. The results from these workshops will help to inform future debate on which proposals to take forward. This work was funded by grant from Cambridgeshire Horizons Housing Growth Fund.

The meeting also received details of the proposals to further develop the ideas for an 'Eastern Gateway' in Soham. This is a proposal to help redress the current elongated shape of Soham by opening up an eastern gateway from the Soham bypass into the centre of the town. A steering group will oversee the development of a concept plan for the Eastern Gateway. The timetable provides for a final report on this plan to be available by January 2011, and will

include consultation with the public and key stakeholders. This work is being funded by a Rural Masterplan grant from the Department of Communities and Local Government and Department of Environment, Food and Rural Affairs.

The Growth Delivery Sub Committee next meets on 6th July when it will hear about transport issues in Ely.

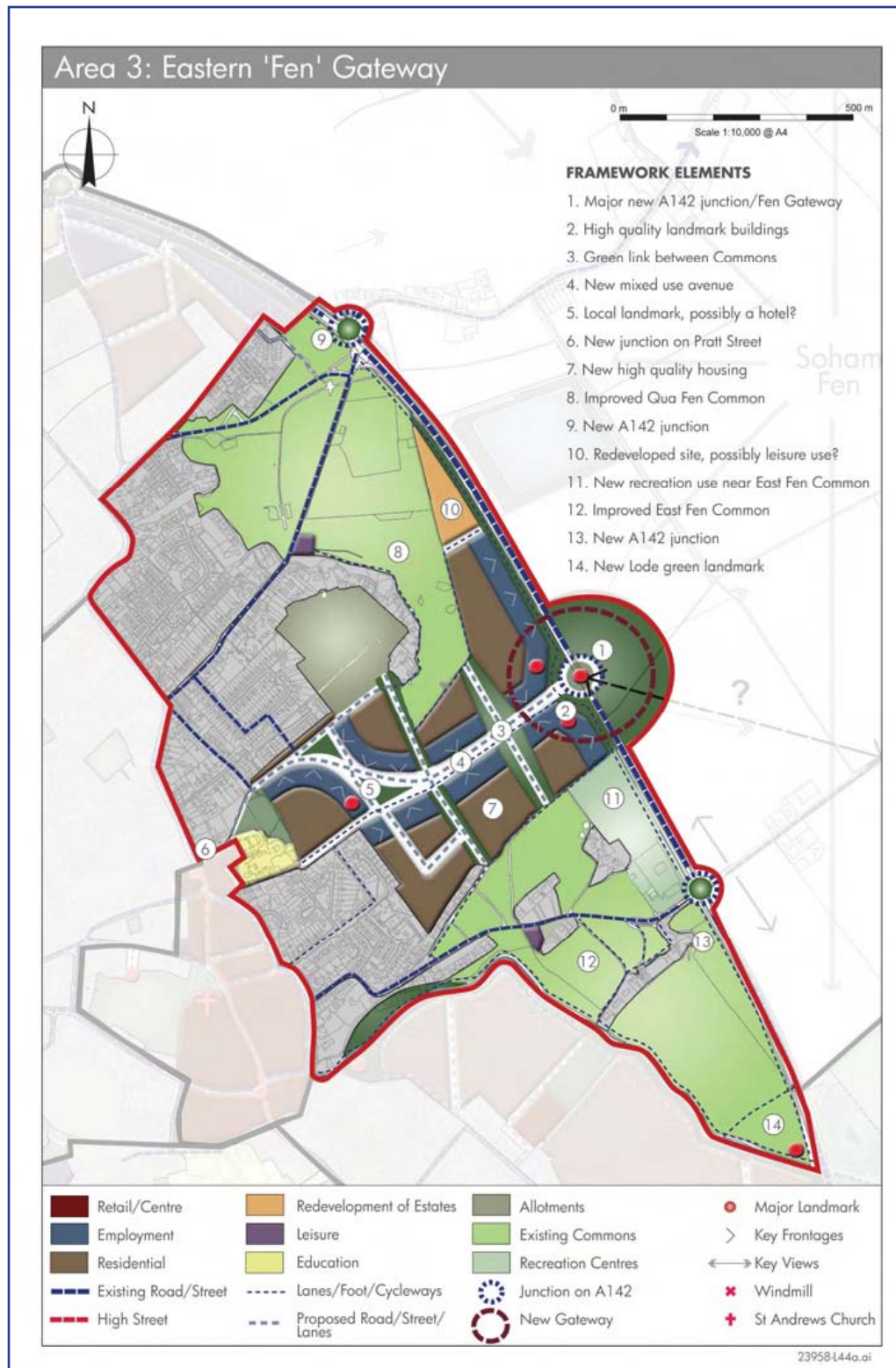



Littleport Masterplan

The Littleport Masterplan is now at the options stage. At the Littleport Masterplan Working Party Meeting held on 27th April 2010, the consultants presented their initial ideas for the future development of the town, based on the feedback from the public consultation and the background research reports.

These ideas will be worked up into strategic options and be available for everyone to view and comment on at the next public exhibition being held on **Sunday 27th June from 11am – 4pm and Monday 28th June from 10am-7pm at Littleport Village Hall.**



Local Development Framework

Two consultations are imminent in relation to the statutory planning framework for the District – the Local Development Framework :

The Draft Ely Area Action: Plan Options Paper

The Draft Site Allocations Options Paper

These are looking at potential site options for housing, employment, retail, gypsy and traveller development, and the delivery of infrastructure to support growth (including

schools, health care facilities and transport improvements).

The Options papers build on the Masterplan work by looking in detail at the suitability, availability and deliverability of sites, and comprehensively testing site options.

Consultation on the Options Papers runs from 5th July to 16th August 2010. Questionnaires will be available on line or by phoning the Forward Planning Team on 01353 665555. If you want to put your questions to officers, market stalls will be held in Ely on Saturday 3rd July and Thursday 8th July from 9.00 am – 1.00 pm.

Keep in touch with future developments

If you would like to keep in touch with future growth delivery work in both Ely and the surrounding district,

- Ask to be included on the Masterplan contact database to receive the newsletter updates.
- Look out for updates on the District Council's website under the Masterplan and Local Development Framework sections www.eastcambs.gov.uk
- Send in your thoughts and ideas,
- Contact a member of the Growth Delivery Sub Committee (details below).

Email – masterplan@eastcambs.gov.uk

Write to Masterplanning, East Cambridgeshire District Council, The Grange, Nutholt Lane, Ely, Cambs CB7 4EE

Telephone – 01353 665555

Growth Delivery Sub Committee

This Sub Committee has been set up by the Strategic Development Committee of the Council to make recommendations on the implementation of the Growth Delivery programme, taking into account relevant resources.

Their role is to ensure a co-ordinated approach to the longer term development of Ely, Soham and Littleport, taking into account their relationship with the wider district.

Working Party members are:

Councillor Peter Moakes (Chairman) – telephone 01353 659910

Councillor Mike Rouse – telephone 01353 645949

Councillor Ian Allen – telephone 01353 664993

