

QUEEN ADELAIDE



© City of Ely Council

1. Settlement characteristics

Queen Adelaide is a hamlet located just over 1 mile northeast of Ely. Development lies on both sides of the B1382 and is intersected by 2 railway lines. There is a third railway line on the eastern edge of the village – but no railway station.

The hamlet is small and is included in the Parish of Ely. It is surrounded by open countryside and has had minimal growth in the past decade. Services within the village are very limited with a car sales garage, a village hall, a public telephone and a bus service only one day a week. The main features of the village are shown on Map xxx.

2. Key statistics

<i>Queen Adelaide</i>	
<i>Population¹</i>	230
<i>Dwellings² (est)</i>	104
<i>New dwellings built 2001-2011 (net)</i>	1
<i>Estimated new dwellings 2012-2031</i>	
<i>Employment</i>	
<i>Existing public transport services</i>	One bus service to Ely every Thursday morning, operated by Ely Dial-a Ride

3. Housing

Queen Adelaide is likely to continue to grow at a slow rate, with new housing being built on suitable ‘infill’ sites within the village. No new housing allocation sites are proposed on the edge

¹ Population for Queen Adelaide (mid-2010), Cambridgeshire County Council Research Group

² Dwellings in Queen Adelaide (mid-2010), Cambridgeshire County Council Research Group

of the village. A ‘development envelope’ has been drawn around Queen Adelaide to define the built-up part of the village where infill development may be permitted. The purpose is to prevent sprawl into the open countryside. Development on infill sites will need to be in line with Policy xx.

Outside the development envelope, housing will not normally be permitted – unless there are exceptional circumstances, such as essential dwellings for rural workers, or affordable housing. Housing schemes outside the development envelope will be assessed against Policy xx and other Local Plan policies as appropriate.

4. Employment

There are a limited number of current businesses within the village, but there are two large employment sites close by, The Potter Group, and DS Smith. The District Council is keen to retain employment land and premises in order to support local economic growth. Proposals to re-use any employment sites for other purposes will only be permitted in certain circumstances (see Policy xx).

No new employment allocation sites are proposed on the edge of Queen Adelaide. However, suitable new employment proposals within or on the edge of the village will be supported in principle, subject to Policies xx, xx and xx.

5. Infrastructure and community facilities

Residents in Queen Adelaide have indicated a desire for improvements to infrastructure and community facilities in the village. A list of priorities is set out in the table below.

	<i>Priority</i>	<i>Suggestions</i>
1	Improvements to existing/new village hall	
2	Improvements to pedestrian/cycle routes	Improved footpaths and cycle routes required, especially to river area and along Ely Road (safety concerns)
3	Provision of a new children’s play area	
4	Open space improvements	Improvements to open space to include the river area.
5	Improvements to road/transport infrastructure	Reduce speed of traffic along B1382 and an improved junction at river bridge.

The top priority expressed by residents is for a new or improved village hall. Other improvements to community facilities include a new children’s play area. The second priority is for improved pedestrian and cycle routes in the village, especially making cycling along Ely Road safer. Residents have also expressed new links to the river area as an important improvement, as well as improvements to the road/transport infrastructure along the B1382, including, reducing the speed of traffic that uses the road, as well as an improved junction at the river bridge. The District Council will work with the Parish Council and County Council to explore options and secure funding for community facilities and transport infrastructure schemes within Queen Adelaide.

The community facilities in Queen Adelaide contribute to the quality of people’s lives. Proposals for new community development that benefits the village will be supported in principle, subject to Policies xx and xx. The loss of community facilities will also be resisted under Policy xx.

6. Spatial strategy for Queen Adelaide (Map xx)

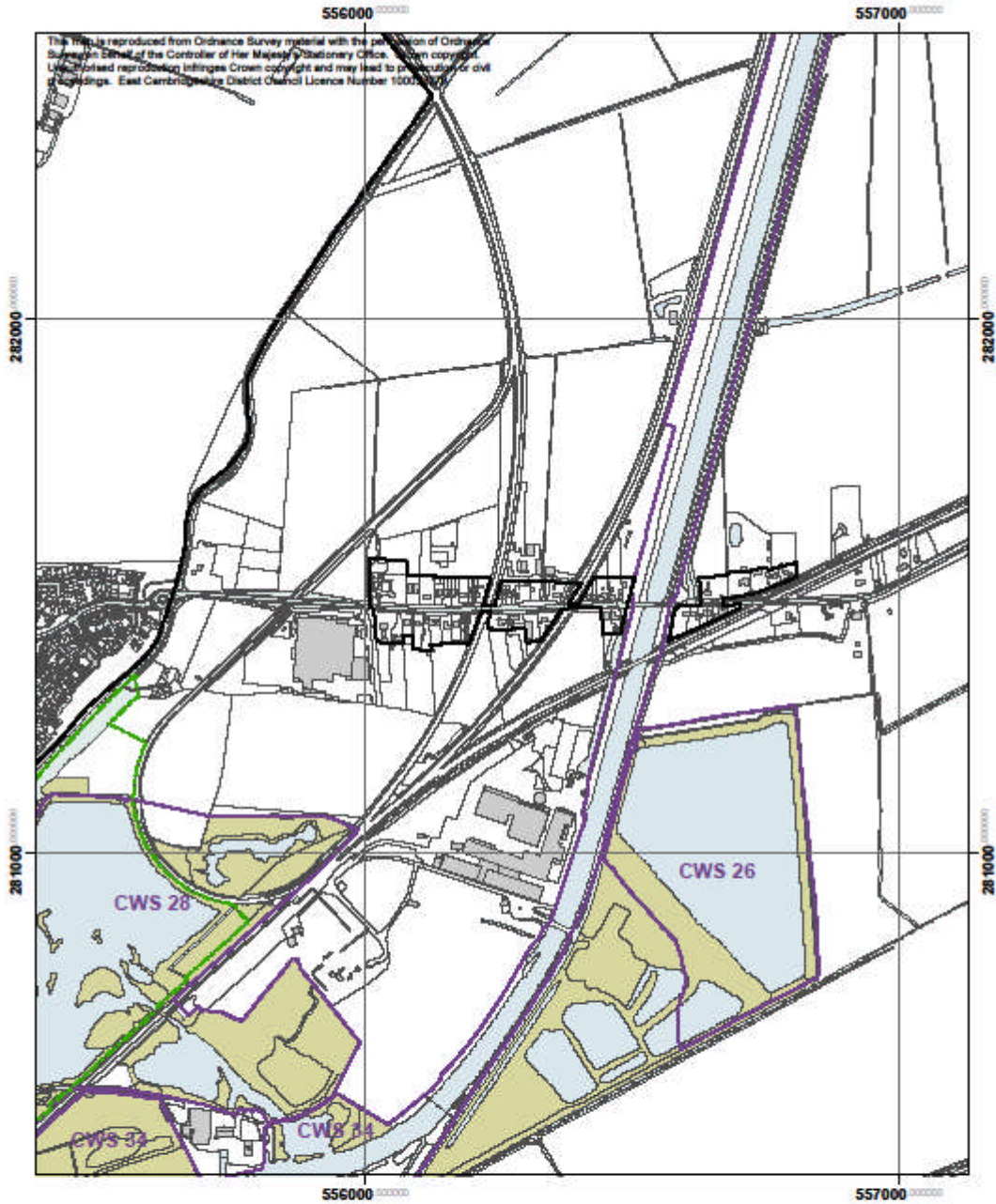

Key			
	Development Envelope		Conservation Area
	Housing allocation		County Wildlife Site
	Employment allocation		Area of International Importance for Wildlife
	Scheduled Ancient Monument		Listed Building
	Historic Parks & Gardens		Site of Special Scientific Interest



**Map x
Queen Adelaide**

N



1:10,000